

Ultra High Resolution with OSD box menu camera



FEATUERS

- ◆ 1/3" SONY EX-view HAD II CCD (960H)
- ◆ DSP:Sony Effio-P
- ◆ Resolution: Color 700TVL
- ◆ Min illumination: 0.00009Lux/F1.2 (sens-up on)
- ◆ Motion detection, Privacy zones, BLC, HLC, CRR, Sens-up, smart IR
- ◆ Electronic shutter adjustable, Mirror function, multi WB models, WDR, NR (3D noise reduction), motion detection zoom in
- ◆ OSD menu, Lightning-proof, back focus adjustable, CS mount, DC12V/AC24V



High Resolution

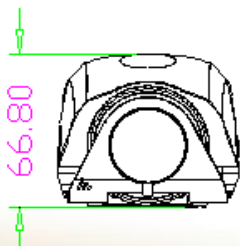
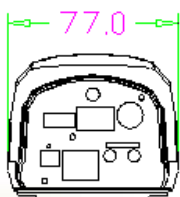
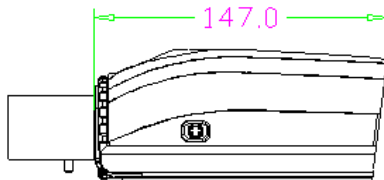

SPECIFICATION

Model	PS-HQ66
Pick-up device	1/3" SONY EX-view HAD II CCD (960H)
Total Pixels	NTSC: 1020 X 508 :520K / PAL: 1020 (H) X 596 (V): 610K
Effective pixels	NTSC:976x494,PAL:976x582
Resolution	Color 700TVL
Min. illumination	Color: 0.02Lux/F1.2, B/W: 0.00009Lux/F1.2(sens-up on)
Scan system	2:1 interlace
Sync system	Internal/Line lock
S/N ratio	more than 55dB
Lens	C/CS mount lens
Electronic shutter	AUTO(1/50(1/60)~1/100,000) /FIXED/MANUAL/FlickerLess
White balance	MANUAL/USER1/USER2/PUSH LOCK/CRR/ANTI CR /ATW
NR	3D noise reduction
Image adjustment	Lightness/Contrast/Sharpness/Tone/Saturation
ATR/WDR	Low/Middle/High
BLC	HLC/BLC/OFF
AGC	ON/OFF
Day&Night	B/W/Color/Auto/ICR
Privacy zones	Off/On(15 areas)
Motion detection	Off/On(4 areas)
Mirror function	Horizontal mirror/Vertical mirror/Horizontal+Vertical/OFF
Gamma	0.45(Default)
OSD menu	8 kinds of language (English/Japanese/French/Spanish/German etc.)
Video output	1.0Vp-p Composite Video Output, 75 Ohm
Power supply	DC12V± 10% , AC10-24V
Power Consumption	200mA(Max)
Operation temp	-20°C ~ 50°C