



#### Key Features

- Adopt 1/2.9" SONY 2.12MP CMOS sensor
- Grain encoding system: H.264, dual-stream output
- 1080P full real-time recording
- Support Onvif, GB28181 optional
- Support mobilephone, WEB, client, platform management software, IE browser
- Alarm linkage snapshot and Email sending
- IP66, POE



#### WIRE INTERFACE

1. Power Supply
2. Network Interface
3. Analog video output

#### Dimension

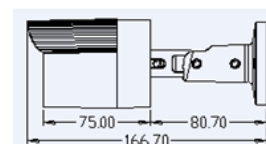
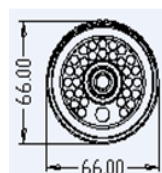

#### SPECIFICATION

Model	PS-682HD-PC
<b>CAMERA</b>	
Image sensor	1/2.9" 2.12MP CMOS sensor
Min.illumination	OLux (IR ON)
IR distance	20-30m(30xΦ5 IR leds)
Electronic shutter	Auto/ manual (1/25~1/10000), FLK
Day/ Night	ICR switch, color, B/W, Auto, ext
Scan system	Progressive scan
Sync system	External
Lens	3.6mm M12 lens (6mm/8mm M12 lens optional)
Lens interface	M12
R/N ratio	≥50db (AGC OFF)
Output	PAL/NTSC adjustable
WDR	Support DWDR
Video parameter	Mirror, 3D noise reduction, sharpness/ lightness adjustable
<b>AUDIO/VIDEO COMPRESSION</b>	
Video compression	H.264
Encoding features	Dual-stream, main-stream: 1080P@25fps, sub-stream: D1@25fps
Max. image resolution	1920X1080
Video bit rate	Constant bit rate, variable bit rate (16kbps-8000kbps)
Stream type	Complex stream/ video stream
Audio compression	G.711A
Audio bit rate	64Kbps

<b>NETWORK</b>	
Motion detection	Can be set to a single detection zone, multi-level sensitivity can be set
Privacy zones	4 zones
Snapshot	Support JPEG format, max. resolution based on snapshot resolution
Password protection	Support
Alarm function	Support video loss, network anomaly, tampering alarm, storage exception, motion detection, etc.
Intelligent analysis	/
Mobile surveillance	Apple, android
Protocol	TCP/IP, UDP, HTTP, DHCP, RTSP, DDNS, NTP, PPPOE, UPNP, SMTP, ONVIF
Port protocol	ONVIF, GB28181 optional
Other	/
<b>INTERFACE</b>	
Network interface	RJ45 10M/100M adaptive
Analog video output	1CH 1.0Vp-p complex video output
Audio	/
Alarm	/
TF card	/
RS485	/
Reset	/
<b>GENERAL</b>	
Operating temperature /humidity	-20°C ~ 55°C/0%-90%
Protection grade	IP66
Power supply	DC12V/ POE optional
Power consumption (max.)	<6W
Dimensions(mm)	66(W)*66(H)*166.7(L)mm
Weight/PCS(g)	380g